

Lock 'n Roll Microseal Closure

Purpose

- A drainable pouch is open at the bottom to allow emptying. It requires a closure on the bottom to keep it closed
- Empty your pouch when it is 1/3 to 1/2 full of discharge or gas
- The **Lock 'n Roll** microseal closure is an integrated closure on a drainable pouch

Before you apply your new pouch, close the pouch tail (see Figure 4 and Figure 5)



1
Opening
Lift from the centre of the transparent flap

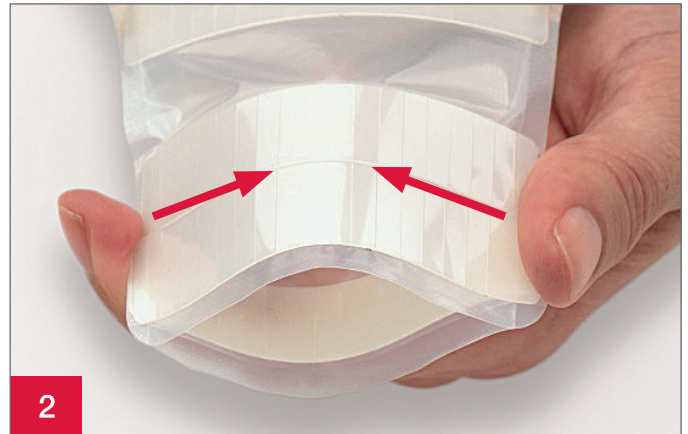

2
Draining
Position fingers on both sides of the pouch tail, between the ribbed strips, and squeeze from the sides. Continue to hold the pouch open for cleaning



3
Cleaning
Clean and dry the inside of the pouch tail. Wipe the outside edge of the pouch tail

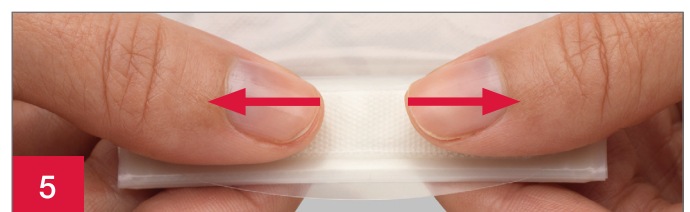

4
Closing
Roll the pouch tail up tightly three times. Fold flap down aligning the fasteners together (Figure 4)

To close, start at the centre and press. Continue pressing to the outer edges. You will feel the fasteners seal together (Figure 5)

Lock 'n Roll Microseal Closure

FREQUENTLY ASKED QUESTIONS

Q: How do I know my pouch is securely fastened?

A: Aligning and pressing the centre of the security flap to the outer edges will allow you to feel the interlocking fasteners seal and ensure your pouch is securely closed.

Q: Will the closure work when it is wet?

A: The material used on the closure is water-resistant and can be securely closed even when it is wet, but will work best when dry.

Q: Will the closure show through my clothes?

A: The closure is designed to be discreet with its slim profile, and is not noticeable underneath most clothes.

Q: Is the closure comfortable against my body?

A: The slim profile of the curved outlet is designed to conform to the body's natural curves providing the utmost comfort.

Q: Will the closure open accidentally?

A: Laboratory testing has shown that the interlocking fasteners are secure when closed properly.

Q: My output is very liquid. Are there any suggestions to make emptying easier?

A: With the closure's unique design, you may want to control the draining of the liquid contents by unrolling the pouch tail two times and holding the last flap up. You can then unroll this flap slowly.

Q: Will people hear me open the pouch when I need to empty it in a public restroom?

A: The material used on the closure is quiet and will not make a "ripping" noise when the security flap is opened.

**For more information or samples
please call Customer Engagement on:**

Australia 1800 880 851

New Zealand 0800 678 669

Routine follow-up with your healthcare professional is recommended.

Prior to using any ostomy products/accessories be sure to read all product inserts and labels.

The Hollister logo, Lock 'n Roll and "Healthy skin. Positive outcomes." are trademarks of Hollister Incorporated.
© 2018 Hollister Incorporated. AUH135.

Australia
PO Box 375
Box Hill, VIC 3128
1800 880 851
www.hollister.com.au

New Zealand
PO Box 62-027
Mt Wellington, Auckland
0800 678 669
www.hollister.co.nz